



Flightcell International Ltd
98 Vickerman St
Nelson 7010
New Zealand
Ph: +64 3 545 8651
F: +64 3 548 8091
email: info@flightcell.com
Website: www.flightcell.com

Active L1/L2 GPS & Iridium Antenna: Flat mount, P/N: See table:

SPECIFICATIONS

REVISIONS			
REV	DESCRIPTION	DATE	APPROVED
4.0	Added Not on T in Manufacturer's P/N's. F040819.	25-Jul-2016	J.Glasgow
5.0	Corrected mounting hole description. F040711.	16-Feb-2017	J.Glasgow
6.0	Added ANP_00040 and Manufacturer Details. F05-000	08-Mar-2018	J.Glasgow

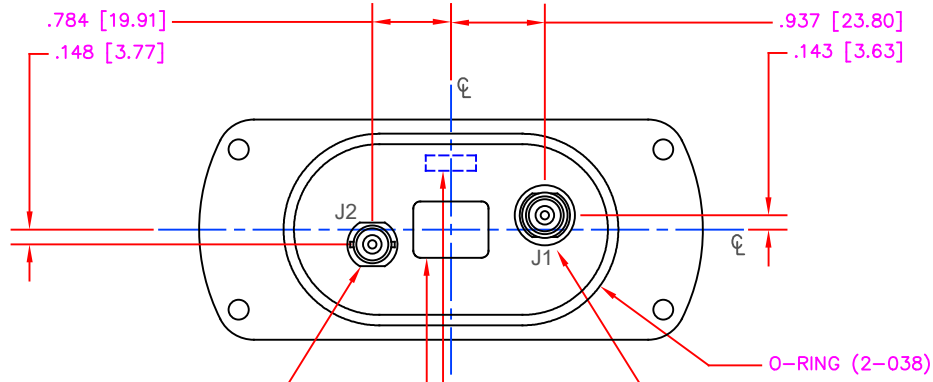
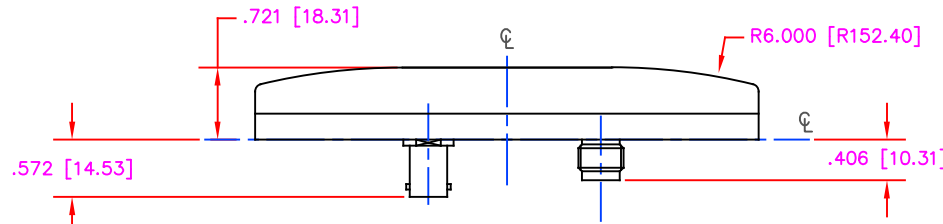
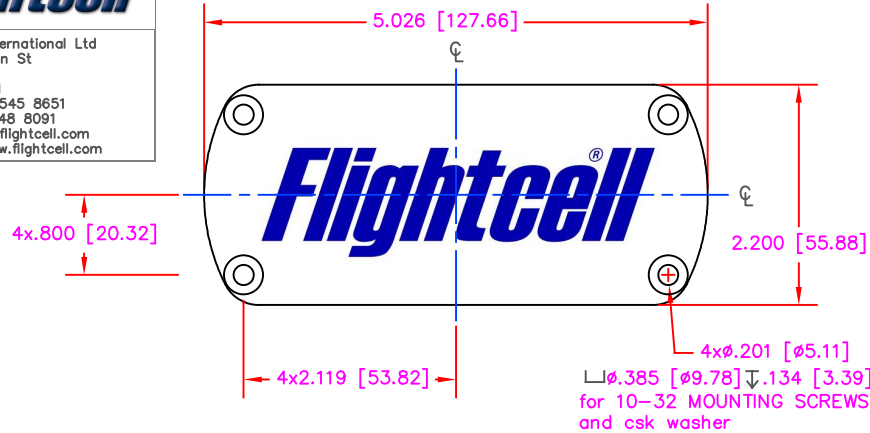

GPS: BNC Female (J2, Blue)
DATE STAMP/
NAMEPLATE
Iridium: TNC Female (J1, Red)
O-RING (2-038)
(+2.5 to +30) Volts DC

ELECTRICAL:

	IRIDIUM		GPS	
FREQUENCY:	(1610.0 - 1626.5) MHz		L1: (1575.42 ±13)	
RADIATION PATTERN:	HEMISPHERICAL		HEMISPHERICAL	
POLARIZATION:	RHCP		RHCP	
VSWR:	< 1.5:1		< 1.5:1	
GAIN (dB):	4 ft G.P.	Free Space	F.S.	4 ft G.P
@ 90° (Zenith):	+4.9	+5.0	+ 4.6	+ 2.9
@ 10° Elevation:	-1.0	-2.5	- 2.5	- 1.8
@ 20° Elevation:	+1.5	-0.5	- 1.1	+ 0.7
@ 30° Elevation:	+2.4	+1.0	+ 0.5	+ 1.7
@ 60° to 90° Elevation:	>+3.3	>+2.7	> 3.6	> 2.1
BEAM WIDTH (3dB):	129 °	98 °-106 °	103 °	146 °
AXIAL RATIO @ Zenith:	2 dB		2 dB	
POWER HANDLING:	30 W		1 Watt	
LIGHTNING PROTECTION:	DC GROUNDING		DC GROUNDING	
FILTER (REJ. @1616 MHz):			> 60 dB	
LNA GAIN:	N/A		(33.0+/-1.0) dB, 20dB (-A2- Option)	
LNA P 1dB Out:	N/A		+16 dBm	
LNA NOISE FIGURE:	N/A		2.8 dB (Filter loss is Included)	
VOLTAGE/CURRENT:	N/A		(+2.8 TO +28) Volts DC / (30 TO 50) mA	

MECHANICAL:

SIZE: WIDTH: 2.20 in. [55.88 mm], LENGTH: 5.026 in [127.66 mm], HEIGHT: 0.721 in. [18.31 mm]

WEIGHT: 8.3 oz (235 g)

FINISH: SKYDROL RESISTANT POLYURETHANE ENAMEL, AND NICKEL PLATING

MATERIAL: 6061-T6 ALUMINUM ALLOY BASE COMPOSITE RADOME, IMPACT, ABRASION, UV, SOLVENT, AND SKYDROL RESISTANCE, FIRE RETARDANT

CONNECTOR: IRIDIUM: TNC FEMALE (J1, Red); GPS: BNC FEMALE (J2, Blue)

MOUNTING: FLAT FIXED MOUNT; O-RING & 4 x 10-32 MOUNTING SCREWS PROVIDED

ENVIRONMENTAL:

TEMPERATURE: -67 °F TO +185 °F [-55 °C TO +85 °C]

ALTITUDE: 70,000 ft.

VIBRATION: > 30 G's

LEAKAGE: HERMETICALLY SEALED

FEDERAL & MILITARY SPECIFICATIONS:

DESIGN TO: FAA TSO-C144, DO-160D, D0-228, MIL-C-5541, MIL-E-5400, MIL-I-45208A, MIL-STD-810, AND SAE J1455

FLIGHTCELL P/N:	DESCRIPTION:	OLD FLIGHTCELL P/N:	COLOR:	MANUFACTURER: ANTCOM
ANP_00002	L1 GPS (BNC) & IRIDIUM (TNC)	FCANTBNC3VC	LUSTERLESS BLACK #37038 PER FED-STD-595B	S5GIR1516RR-AP-XBT-4(F)
ANP_00003	L1 GPS (BNC) & IRIDIUM (TNC)	ANTDTNCBNC3VC	GLOSS WHITE #17925 PER FED-STD-595B	S5GIR1516RR-AP-XBT-1(F)
ANP_00004	L1 GPS (SMA) & IRIDIUM (TNC)	ANTDTNC3MA3VC	GLOSS WHITE #17925 PER FED-STD-595B	S5GIR1516RR-AP-XST-1(F)
ANP_00012	L1 GPS (BNC) & IRIDIUM (TNC) with TSO Certification.	-	GLOSS WHITE #17925 PER FED-STD-595B	5G1516RR-AP-XBT-1(F)
ANP_00014	L1 GPS (BNC) & IRIDIUM (TNC) with TSO Certification.	-	LUSTERLESS BLACK #37038 PER FED-STD-595B	5G1516RR-AP-XBT-4(F)
ANP_00016	L1/L2 GPS (BNC) & IRIDIUM (TNC).	-	GLOSS WHITE #17925 PER FED-STD-595B	S5GIR1216RR-AP-XBT-1(F)
ANP_00040	L1/L2 GPS (TNC) & IRIDIUM (TNC).	-	GLOSS WHITE #17925 PER FED-STD-595B	5G1516RR-AP-XTT-1

NOTES: UNLESS OTHERWISE SPECIFIED:
1. DIMENSIONS IN BRACKETS ARE IN MILLIMETERS [mm]
2. ALL SCREWS ARE SUPPLIED BY FLIGHTCELL
3. THE 'F' AT THE END OF MANUFACTURERS P/N IS OPTIONAL AND ONLY PRESENT ON PARTS THAT HAVE HAD FLIGHTCELL LOGO PRINTED BY MANUFACTURER

QUANTITY REQD	DESCRIPTION	PART NO	MATERIAL	FINISH	ITEM NO
4	MOUNTING SCREW: (10-32, 1")	MS24693C276	-	-	3
4	WASHER: CSK Ø.370 x 100' .110 THICK	3G15P1001-70	-	-	2
1	O-RING	2-038-N756-75	-	-	1

UNLESS OTHERWISE SPECIFIED DIMENSIONS ARE IN INCHES		TOLERANCES UNLESS OTHERWISE SPECIFIED	
FRACTIONS	DECIMALS	ANGLES	
± 1/8"	.005 .020 .030	± 1°	
TOLERANCE SYM PER ANSI Y14.5		REMOVE ALL BURRS	
BREAK EXTERNAL EDGES .005 TO .015		FILETS R .005 TO R .030	
SCREW THREADS PER ANSI B97.9		DIA'S ON A COMMON & .005	
MACHINED SURFACES		DO NOT SCALE DRAWING	

Flightcell International Ltd NELSON NEW ZEALAND

FLAT FIXED MOUNT
ACTIVE IRIDIUM/GPS
ANTENNA

DRAWN: J.GLASGOW 16-FEB-17
CHECKED: J.MACE 16-FEB-17
ENGINEER: J.MACE 16-FEB-17
APPROVED: J.GLASGOW 16-FEB-17
CAD FILE NO: E5340

SCALE 1/1 SHEET 1 OF 1