

GA OPTION TOP VIEW

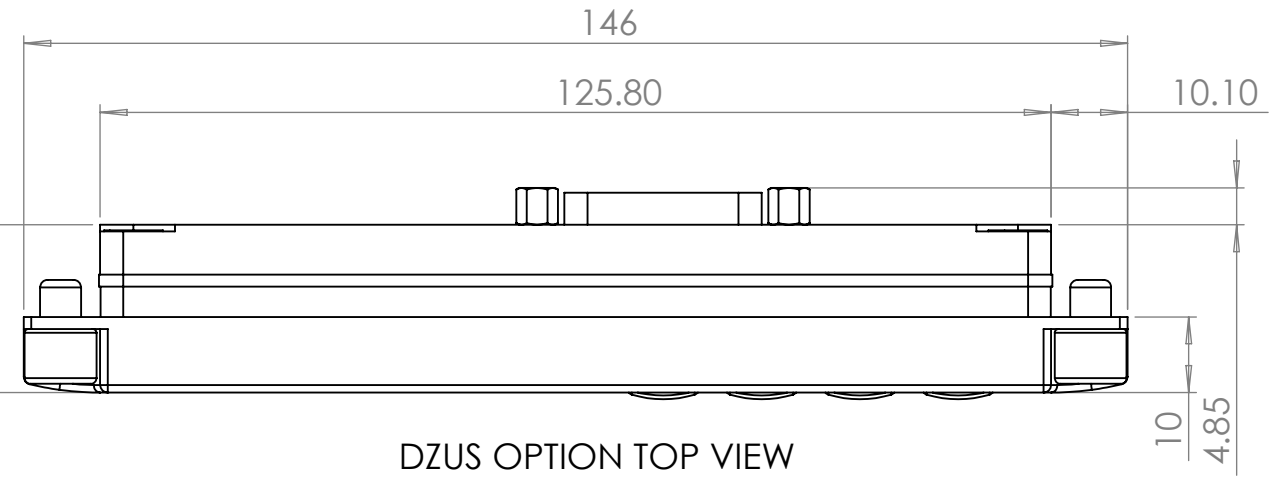

DZUS OPTION TOP VIEW

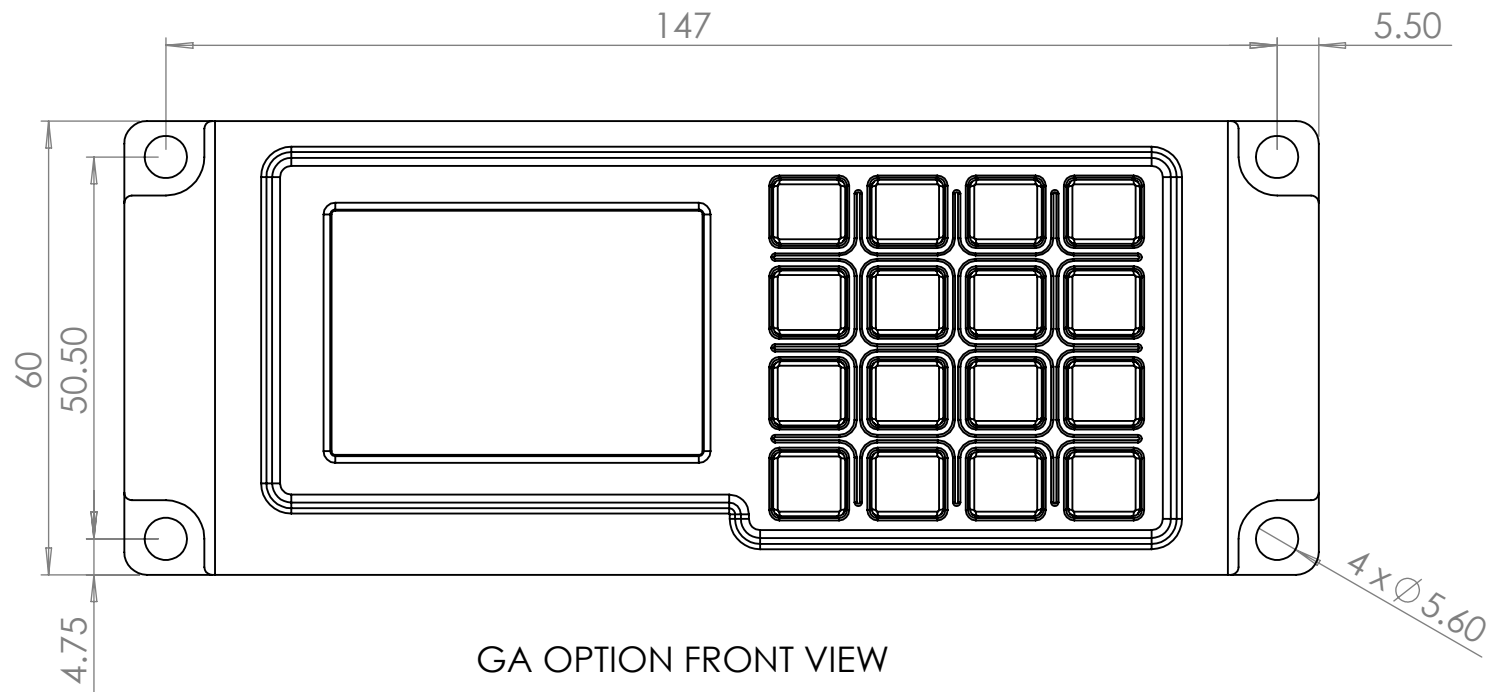

GA OPTION FRONT VIEW

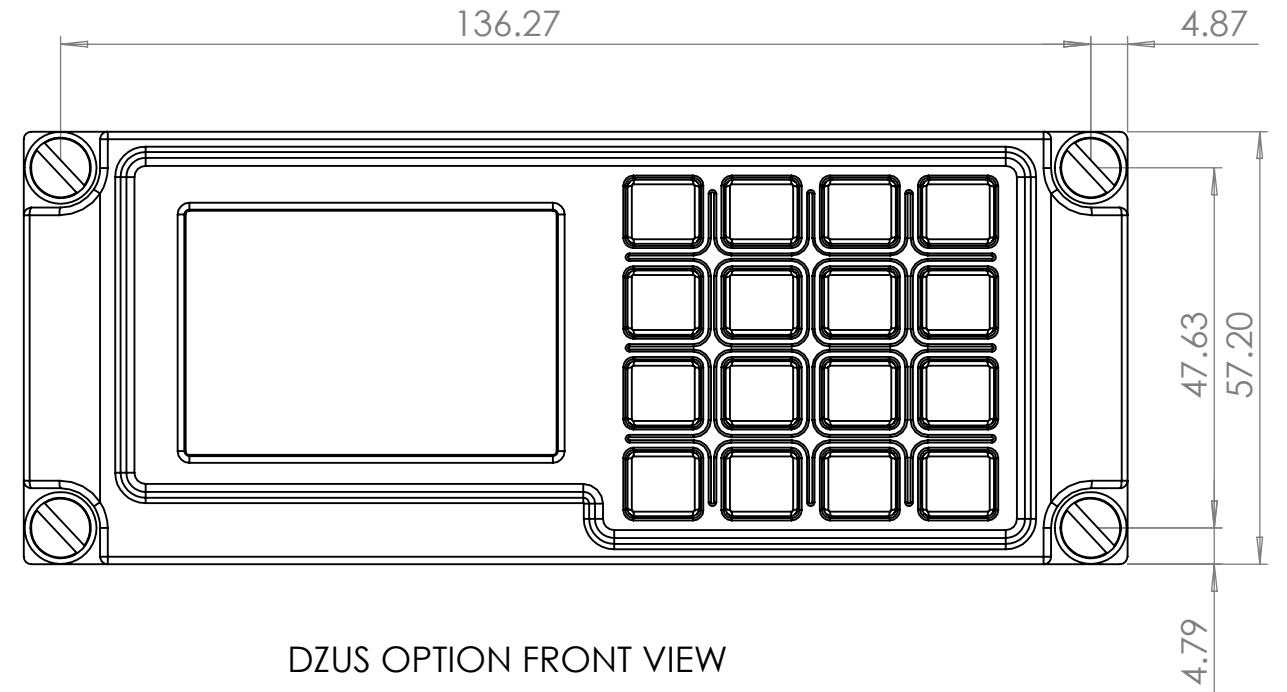

DZUS OPTION FRONT VIEW

REV	DESCRIPTION	DATE	APPD
1.0	Initial Drawing Release (FCN0501).	01/07/13	JG

GENERAL LIMITS (UNLESS STATED)
 LINEAR: +/- 0.20
 HOLES: +/- 0.10
 ANGLES: +/- 1°
 ALL DIMENSIONS IN mm

MATERIAL: 6061 T6 Aluminium
 FINISH: Bonderite (Yellow Chromate)

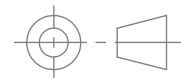

DO NOT SCALE OFF DRAWING
 IF IN DOUBT ASK!

DRAWN: JG
 CHK'D: JG
 APPV'D: FT

ORIGINAL SCALE: 1:1
 DRAWING SIZE: A3



Flightcell International Ltd
 PO Box 1481, Nelson, New Zealand
 +64 3 545 8652 www.flightcell.com

ORDERING OPTIONS:	
DZMx DZUS FRONT PANEL OPTION:	DZP_05-001
DZMx GA FRONT PANEL OPTION:	DZP_05-011
TITLE:	DZUS/GA Faceplate
PART NO:	DZP_05-001/011 VERSION: 1.0
PROJECT:	FLIGHTCELL Remote Head
DWG NO:	DRW_DZ5_005 SHEET 1 OF 1